

THE HONEYSUCKLE

4 Bedroom Home



Artist's Impression

A stunning four bedroom detached home.

Plots: 9

THE HONEYSUCKLE

4 Bedroom Home

Ground Floor



First Floor

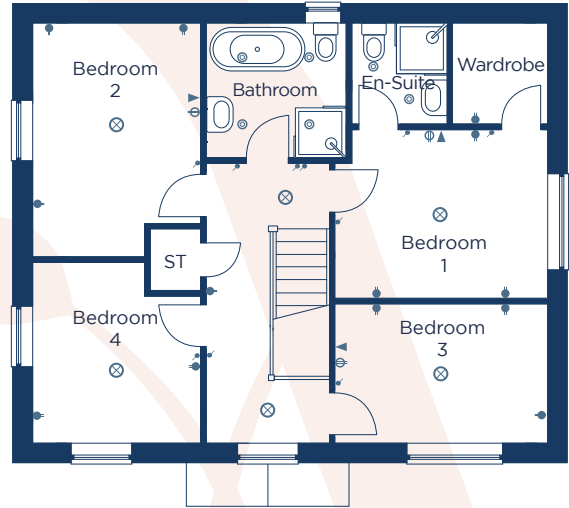

Kitchen / Dining
7500 x 3900 24'7" x 12'10"

Lounge
3800 x 3500 12'6" x 11'6"

Study
3000 x 2300 9'10" x 7'7"

W.C
2000 x 1100 6'7" x 3'7"

Utility
1600 x 2900 5'3" x 9'6"

Bedroom 1
3800 x 3000 12'6" x 9'10"

Wardrobe
1700 x 1800 5'7" x 5'11"

En-Suite
1700 x 1800 5'7" x 5'11"

Bedroom 2
3000 x 4175 9'10" x 13'8"

Bedroom 3
3800 x 2600 12'6" x 8'6"

Bedroom 4
3000 x 3225 9'10" x 10'7"

Bathroom
2500 x 2400 8'2" x 7'10"

● Low level socket

⊖ High level socket

⊗ Pendant light

⊕ External light

— Fluorescent light

⊙ Spotlight

⦿ Light switch

▶ TV point

▷ BT point

CONSUMER CODE FOR HOME BUILDERS

www.consumercode.co.uk

danumhomes.co.uk

All information contained in this leaflet is taken from design intent material and may be subject to further design development. Images are for illustration only and do not form part of any contract of sale. The dimensions and layouts given are estimated and for guidance only and are subject to chosen plot. T2 6662 Revision Date: 09.06.26 Revision: 02

The Vines