

# THE GUELDER

4 Bedroom Home



Artist's Impression

A spacious four bedroom detached home.

Plots: 2

# THE GUELDER

4 Bedroom Home

Ground Floor

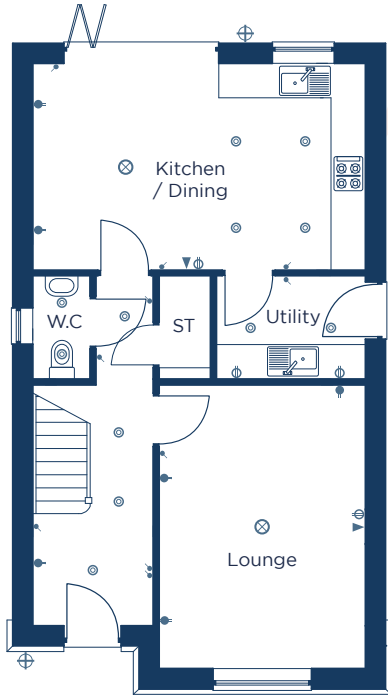

First Floor

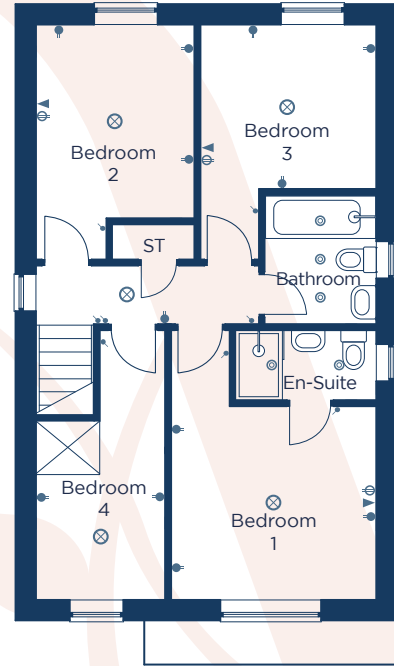

**Kitchen / Dining**  
5800 x 3600    19'0" x 11'10"

**Lounge**  
3600 x 4950    11'10" x 16'3"

**W.C**  
1000 x 1800    3'3" x 5'11"

**Utility**  
2600 x 1800    8'6" x 5'11"

**Bedroom 1**  
3500 x 4600    11'6" x 15'1"

**En-Suite**  
2400 x 1200    7'11" x 3'11"

**Bedroom 2**  
2700 x 4000    8'10" x 13'2"

**Bedroom 3**  
3000 x 4000    9'10" x 13'2"

**Bedroom 4**  
2200 x 4600    7'3" x 15'1"

**Bathroom**  
1900 x 2200    6'3" x 7'3"

● Low level socket

⊖ High level socket

⊗ Pendant light

⊕ External light

— Fluorescent light

⊙ Spotlight

⦿ Light switch

▶ TV point

▷ BT point

**CONSUMER CODE FOR HOME BUILDERS**

[www.consumercode.co.uk](http://www.consumercode.co.uk)

[danumhomes.co.uk](http://danumhomes.co.uk)

All information contained in this leaflet is taken from design intent material and may be subject to further design development. Images are for illustration only and do not form part of any contract of sale. The dimensions and layouts given are estimated and for guidance only and are subject to chosen plot. T2 6662 Revision Date: 09.06.26 Revision: 02

The Vines