

THE BLACKTHORN

3 Bedroom Home



Artist's Impression

A modern three bedroom detached home.

Plots: 1

THE BLACKTHORN

3 Bedroom Home

Ground Floor

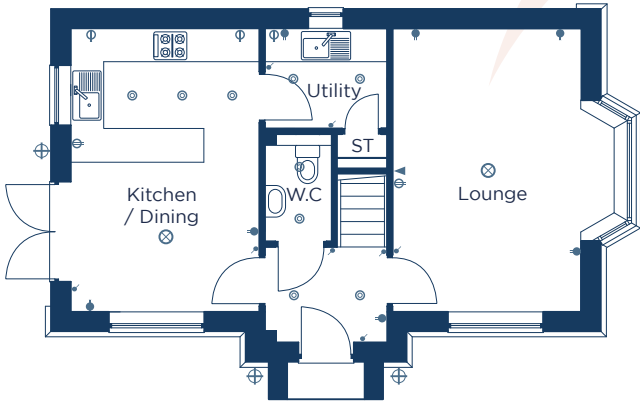

First Floor



Kitchen / Dining
3400 x 5100 11'2" x 16'9"

Lounge
3400 x 5100 11'2" x 16'9"

W.C
1200 x 1930 3'11" x 6'4"

Utility
2200 x 1800 7'3" x 5'11"

Bedroom 1
3400 x 3600 11'2" x 11'10"

En-Suite
2300 x 1400 7'7" x 4'7"

Bedroom 2
3400 x 2700 11'2" x 8'10"

Bedroom 3
3400 x 2300 11'2" x 7'7"

Bathroom
2200 x 1750 7'3" x 5'9"

● Low level socket

⊖ High level socket

⊗ Pendant light

⊕ External light

— Fluorescent light

⊙ Spotlight

⦿ Light switch

▶ TV point

▷ BT point

CONSUMER CODE FOR HOME BUILDERS

www.consumercode.co.uk

danumhomes.co.uk

All information contained in this leaflet is taken from design intent material and may be subject to further design development. Images are for illustration only and do not form part of any contract of sale. The dimensions and layouts given are estimated and for guidance only and are subject to chosen plot. T2 6662 Revision Date: 09.06.26 Revision: 02

The Vines